



Building Safety Division  
307 S. Randolph St.  
Champaign, IL 61820  
Phone: 217-403-6100  
Fax: 217-403-6114  
[www.champaignil.gov](http://www.champaignil.gov)

Office Hours:  
7:30 – 8:30 A.M.  
3:30 - 4:30 P.M

## Residential Deck Information

2015 International Residential Code

Building Inspectors: Charles Montgomery -- 403-6115

Patrick Bolger -- 403-6107

### GENERAL

- No permit is needed if **all** of the following items apply: 1) the deck is less than 120 sq. ft., 2) the deck is not attached to the house, 3) the deck is not over 30" (30 inches) above grade and 4) does not serve the exit door required by Section R311.4.
- If a permit is required - provide a site plan showing setback dimensions and property lines.
- Show the dimensions and sq. ft. area of the deck.
- Depth of posts/footings minimum of 32 in. below grade.

### FRAMING

- Wood shall be pressure treated or decay resistant. All fasteners are to be rated by the manufacture for use in treated wood.
- Show size and spacing of floor joists.
- Show size and spacing of posts and location of the postholes.
- Show size of girders and beams supporting floor joists.
- All multi (2 ply, 3 ply, etc.) beams must be fastened together.
- Joist, rim board (acting as bearing) beam or girder bearing is required to have not less than 1.5 inches of bearing on wood or metal and not less than 3 inches on masonry or concrete. A minimum two ½ in. through bolts per these areas or an approved connector. See figures on back sheet.
- If deck is attached to the house, show connection details with size and spacing of fastener.
- Deck is not permitted to connect to masonry veneer or cantilevered joist.
- Joist hangers are required where joists do not rest directly on a girder. Manufacture's specified fasteners are to be used.
- Show the height of the deck above grade.
- For roofed over or screened in decks, include additional information, i.e., header sizes and spans; size, spacing and span of rafters or trusses; and type of roof sheathing, tar paper and shingles. Roof rafters require truss clips. Roofing license is required, unless homeowner is doing the project. Support posts require uplift connectors at bottom and top. Specify ceiling joist or a cathedral ceiling.
- Non-bearing cantilevered floor joists are limited to 2 ft. with a back span of minimum of 6 ft. and require uplift connections at the joist to beam location.

### STEPS / HANDRAILS / GUARDRAILS

- Steps of four or more risers require a handrail 34 in. -38 in. high. Handrail must be graspable and be continuous for the full length of the stairs and return or terminate in newel posts.
- Handrail grip size must be either circular (1-1/4 in. to 2 in.), square (cross section of no more than 2-1/4 in.), or other shapes (1-1/4 in. to 2-3/4 in. with a perimeter of no more than 6-1/4 in.).
- Minimum 10 in. tread and maximum 7 ¾ in. risers on stairs. Tread is measured from nosing to nosing. No more than 3/8" difference on the tread and risers.
- Open riser spaces must be less than 4-in.
- Decks greater than 30 in. above grade require a guardrail. Grade is measured at any point within 36 in. horizontally to the edge of the deck.
- Guardrail height is minimum 36 in. above the deck.
- Openings in the guardrail shall not allow passage of a 4-in. diameter sphere.

**Note:** Revisions on plan resubmittals should be highlighted or clouded so that the changes are readily found during the plan review process. The items listed above do not comprise an exhaustive list. The presence of the information listed above (when applicable) will expedite plan review and issuance of permits.

Thank you for your cooperation. If there are any questions, or if we can be of assistance, please feel free to contact us.

SEE SECTION R507 EXTERIOR DECKS IN THE 2015 IRC FOR ILLUSTRATIONS & SPECIFICATIONS

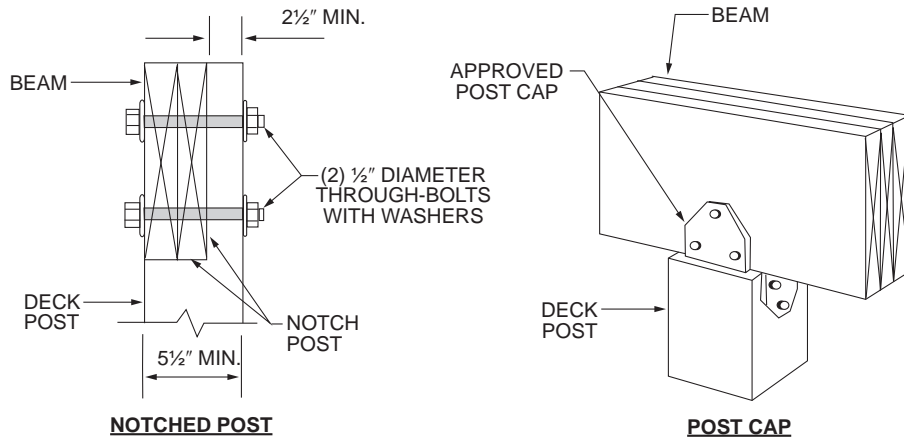

For SI: 1 inch = 25.4 mm.

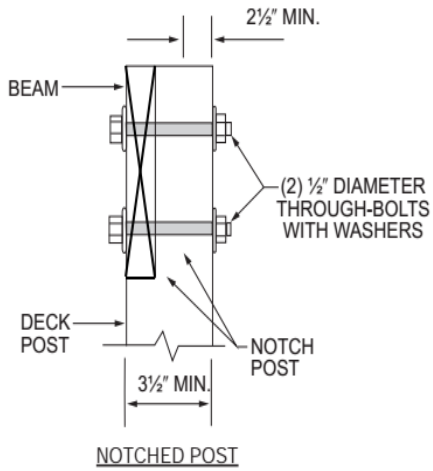

**FIGURE R507.7.1**  
**DECK BEAM TO DECK POST**

